

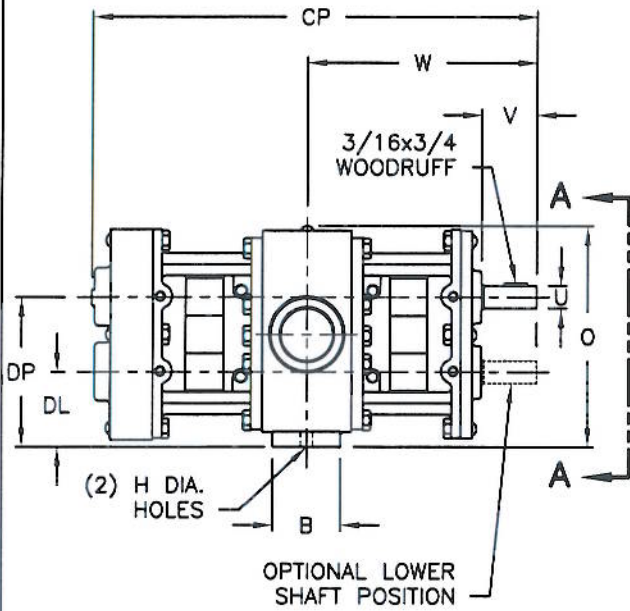

## ROTARY GEAR PUMPS PUMP ONLY

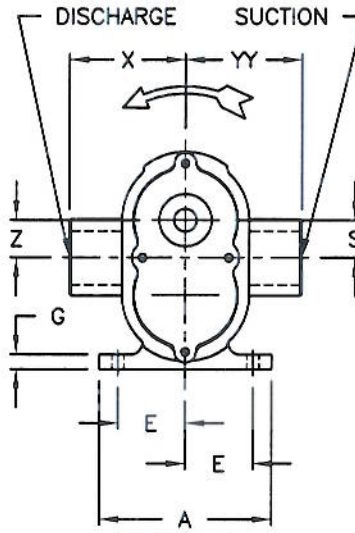

### UPPER DRIVE



VIEW A-A  
LEFT HAND  
ROTATION

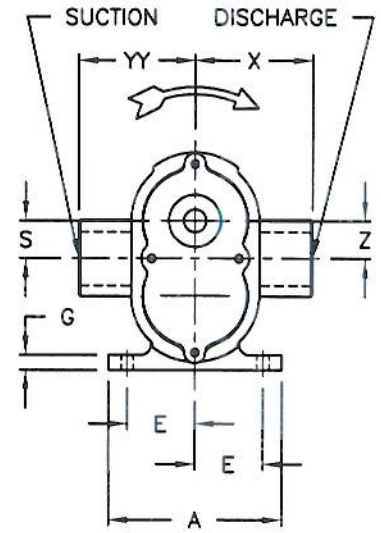

VIEW A-A  
RIGHT HAND  
ROTATION

### LOWER DRIVE

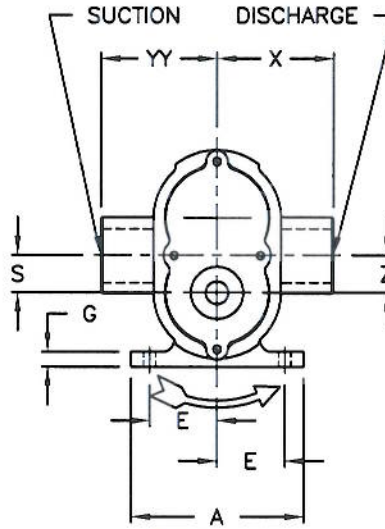

VIEW A-A  
LEFT HAND  
ROTATION

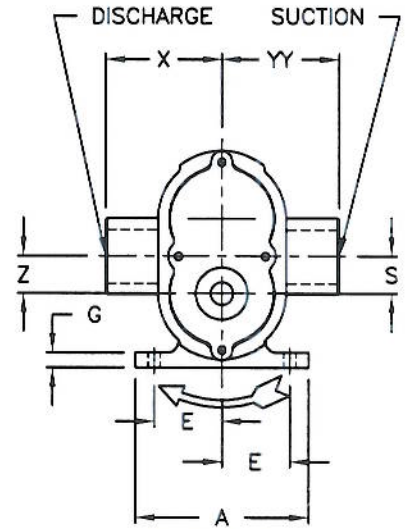

VIEW A-A  
RIGHT HAND  
ROTATION

**NOTES:**

1. All dimensions are in inches (mm).
2. Dimensions may vary  $\pm .25"$  (6).
3. Not for construction purposes unless certified.
4. Discharge and suction ports are:  
F-NPT (Female pipe threads)
5. Use the following notation for pump identification:  
UR = UPPER SHAFT - RIGHT HAND ROTATION  
UL = UPPER SHAFT - LEFT HAND ROTATION  
LR = LOWER SHAFT - RIGHT HAND ROTATION  
LL = LOWER SHAFT - LEFT HAND ROTATION

MODEL	DISCHARGE	SUCTION	A	B	CP	DL	DP	E	G	H
80	1 1/2" F-NPT	1 1/2" F-NPT	5.75 (146)	2.25 (57)	14.88 (378)	2.50 (64)	5.00 (127)	2.25 (57)	.50 (13)	.38 (10)

MODEL	O	S	U	V	W	X	YY	Z
80	7.25 (32)	1.25 (32)	.75 (19)	1.84 (47)	7.66 (195)	3.88 (99)	3.88 (99)	1.25 (32)



## ROTARY GEAR PUMPS ELECTRIC MOTOR DRIVEN ON STANDARD STEEL BASE UPPER DRIVE

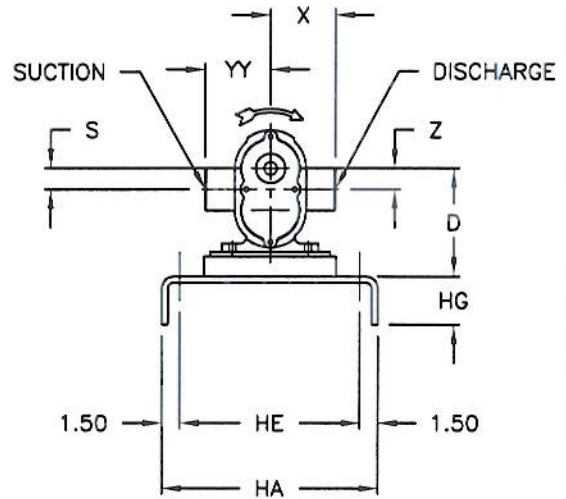
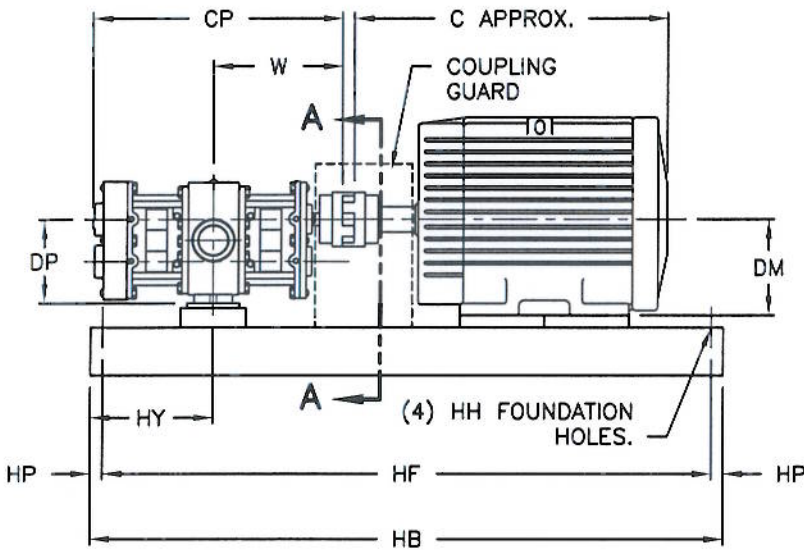

**VIEW A-A  
RIGHT HAND  
ROTATION**

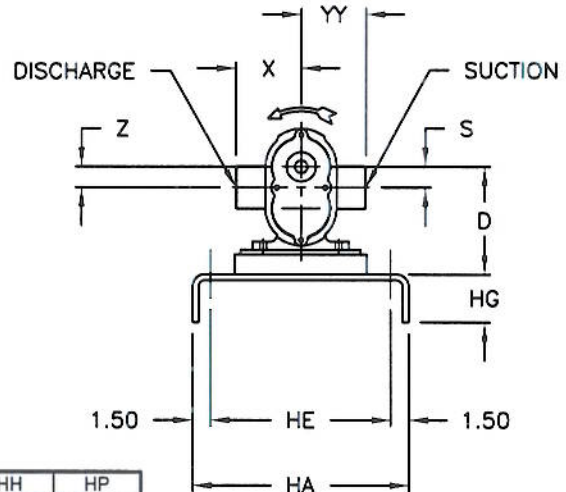

**VIEW A-A  
LEFT HAND  
ROTATION**

**NOTES:**

1. All dimensions are in inches (mm).
2. Dimensions may vary  $\pm .25"$  (6).
3. Not for construction purposes unless certified.
4. Coupling gap may vary  $.13"$ (3) to  $1.13"$ (29).
5. Motor dimension "CP" is approximate. Motor dimensions are not specified as they vary with each motor manufacturer.
6. Discharge and suction ports are:  
F-NPT (Female pipe threads)
7. Use the following notation for pump identification:  
UR = UPPER SHAFT - RIGHT HAND ROTATION  
UL = UPPER SHAFT - LEFT HAND ROTATION

BASE NO.	SIZE	HA	HB	HE	HF	HG	HH	HP
2	12 X 34	12	34	9	32	3	.63	1
		(305)	(864)	(229)	(813)	(76)	(16)	(25)
3	12 X 38	12	38	9	36	3	.63	1
		(305)	(965)	(229)	(914)	(76)	(16)	(25)
4	13 X 42	13	42	10	40	4	.75	1
		(330)	(1067)	(254)	(1016)	(102)	(19)	(25)

MODEL	FRAME	145T	182T	184T	213T	215T	254T	256T
	C	13 (330)	13 (330)	14 (356)	16 (406)	18 (457)	21 (533)	23 (584)
	DM	3.50 (89)	4.50 (114)	4.50 (114)	5.25 (133)	5.25 (133)	6.25 (159)	6.25 (159)
80	BASE NO.	2	2	2	2	3	4	4
	D	5.00 (127)	5.00 (127)	5.00 (127)	5.25 (133)	5.25 (133)	6.25 (159)	6.25 (159)

MODEL	DISCHARGE	SUCTION	CP	DP	HY	S	W	X	YY	Z
80	1 1/2" F-NPT	1 1/2" F-NPT	14.88 (378)	5.00 (127)	7.50 (191)	1.25 (32)	7.66 (194)	3.88 (98)	3.88 (98)	1.25 (32)



## ROTARY GEAR PUMPS ELECTRIC MOTOR DRIVEN ON STANDARD STEEL BASE LOWER DRIVE

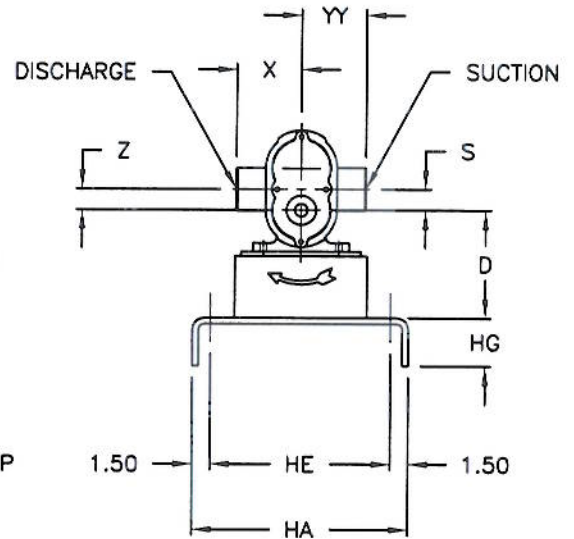
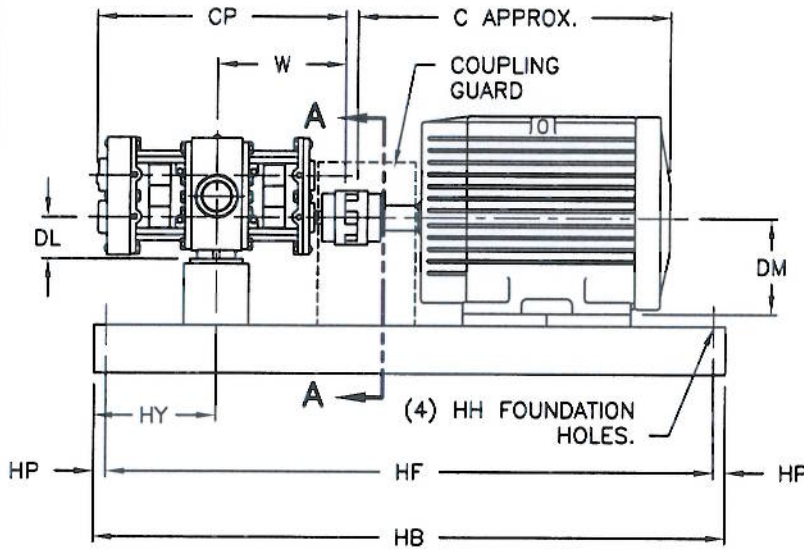

**NOTES:**

1. All dimensions are in inches (mm).
2. Dimensions may vary  $\pm .25"$  (6).
3. Not for construction purposes unless certified.
4. Coupling gap may vary .13"(3) to 1.13"(29).
5. Motor dimension "CP" is approximate. Motor dimensions are not specified as they vary with each motor manufacturer.
6. Discharge and suction ports are:  
F-NPT (Female pipe threads)
7. Use the following notation for pump identification:  
LR = LOWER SHAFT - RIGHT HAND ROTATION  
LL = LOWER SHAFT - LEFT HAND ROTATION

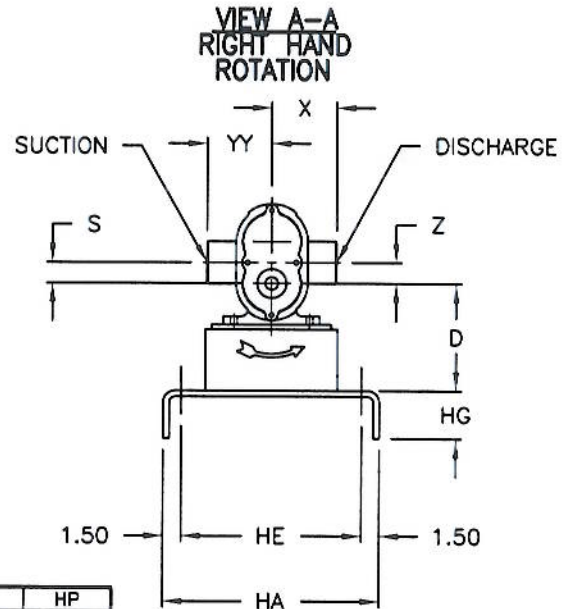

**VIEW A-A  
RIGHT HAND  
ROTATION**

**VIEW A-A  
LEFT HAND  
ROTATION**

BASE NO.	SIZE	HA	HB	HE	HF	HG	HH	HP
2	12 X 34	12	34	9	32	3	.63	1
		(305)	(864)	(229)	(813)	(76)	(16)	(25)
3	12 X 38	12	38	9	36	3	.63	1
		(305)	(965)	(229)	(914)	(76)	(16)	(25)
4	13 X 42	13	42	10	40	4	.75	1
		(330)	(1067)	(254)	(1016)	(102)	(19)	(25)

MODEL	FRAME	145T	182T	184T	213T	215T	254T	256T
	C	13 (330)	13 (330)	14 (356)	16 (406)	18 (457)	21 (533)	23 (584)
	DM	3.50 (89)	4.50 (114)	4.50 (114)	5.25 (133)	5.25 (133)	6.25 (159)	6.25 (159)
80	BASE NO.	2	2	2	2	3	4	4
	D	3.50 (89)	4.50 (114)	4.50 (114)	5.25 (133)	5.25 (133)	6.25 (159)	6.25 (159)

MODEL	DISCHARGE	SUCTION	CP	DL	HY	S	W	X	YY	Z
80	1 1/2"	1 1/2"	14.88	2.50	7.50	1.25	7.66	3.88	3.88	1.25
	F-NPT	F-NPT	(378)	(64)	(191)	(32)	(194)	(98)	(98)	(32)